

ELV, RoHS COMPLIANT

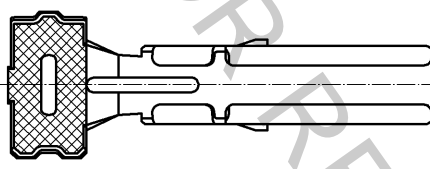
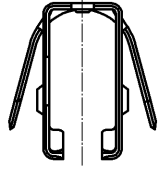
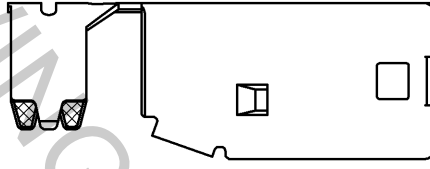
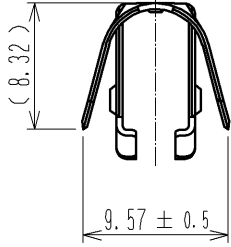
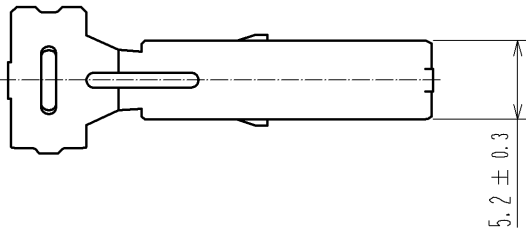
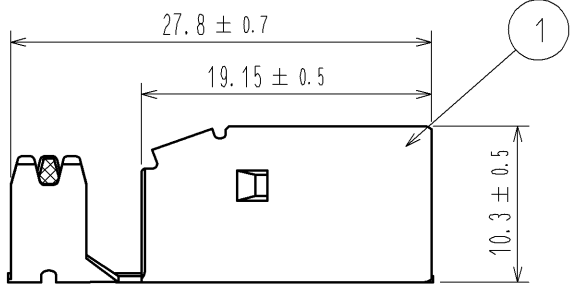

Note 1. Applicable cable  $\phi 5.8 \sim 6.2\text{mm}$

1	COPPER ALLOY	TIN PLATING	T=0.4					
NO.	MATERIAL	FINISH	REMARKS	NO.	MATERIAL	FINISH	REMARKS	
UNITS mm		SCALE 2 : 1	COUNT 	DESCRIPTION OF REVISIONS		DESIGNED	CHECKED	DATE
<b>HIROSE ELECTRIC CO., LTD.</b>	APPROVED	: AR. SHIRAI	11.09.12	DRAWING NO.	EDC4-168931-00			
	CHECKED	: NH. NAKATA	11.09.09	PART NO.	GT17HSK-4S-6CF			
	DESIGNED	: KK. FURUKAWA	11.09.08	CODE NO.	CL767-0270-0-00			
	DRAWN	: KK. FURUKAWA	11.09.08		1/1			